



MLS 7080934 Lake Home

\$79,500

320 sq ft
1 bedrooms
1 baths

38092 County Highway 44
Richville MN 56576

Waterfront: Dead Lake (56038300)

Status: Active

Description:

Turn-key recreational property on Dead Lake in Richville, MN (formerly Troje's Resort)! Enjoy lake life for under \$80K on this owned 16x47 lot with dock slip, sandy hard-bottom shoreline, and future cabin build potential. Located in a quiet bay on 7,535-acre Dead Lake known for excellent fishing, boating, and water sports. Includes a furnished 2006 40' park model camper featuring 1 bedroom, full kitchen, full-size fridge, gas stove, A/C, heat, updated bathroom, skylight, sofa sleeper, recliner, and treated deck. Move-in ready—just pack a bag! Small private association with only 9 cabins and 1 camper. HOA \$2,000/year includes lawn care, garbage, septic, dock install/removal, winterization, shared grounds, playground, paddle boats, kayaks, and more. HOA paid for 2026. Pets allowed.

Additional Details:

Year Built	2006
Lot Acres	2.5
Lot Dimensions	common
School District	549
Taxes	\$480
Taxes with Assessments	\$480
Tax Year	2026

Additional Features:

Fuel: Electric, Propane **Heat:** None

Driving Directions:

Turn right onto 460th St
Turn left onto 410th Ave -2.0 mi
Continue onto Co Hwy 125 -3.0 mi
Turn right onto MN-108 W -3.9 mi
Turn left onto 1st Ave N-0.3 mi
Turn right onto Co Rd 35/Main St
Continue to follow Co Rd 35-1.6 mi
Turn left onto Co Hwy 44/395th St 1.8 mi

Property on right. See sign
Listed By:
REMAX Lakes Region



Affinity Real Estate Inc. participates in the Regional Multiple Listing Service of Minnesota, Inc Broker Reciprocity (sm) program, allowing us to display other broker's listings on our website. All properties are subject to prior sale, change or withdrawal.



Call Affinity Real Estate

218-237-3333

info@affinityrealestate.com



Affinity Real Estate - 600 Park Avenue South - Park Rapids MN 56470



website: www.AffinityRealEstate.com | email: info@affinityrealestate.com | office: 218-237-3333 | fax:218-237-3377



\$79,500
MLS 7080934 Lake Home
38092 County Highway 44
Richville MN 56576

website: www.AffinityRealEstate.com | email: info@affinityrealestate.com | office: 218-237-3333 | fax:218-237-3377



\$79,500

MLS 7080934 Lake Home
38092 County Highway 44
Richville MN 56576



website: www.AffinityRealEstate.com | email: info@affinityrealestate.com | office: 218-237-3333 | fax:218-237-3377



\$79,500
MLS 7080934 Lake Home
38092 County Highway 44
Richville MN 56576



website: www.AffinityRealEstate.com | email: info@affinityrealestate.com | office: 218-237-3333 | fax:218-237-3377

Affinity
REAL ESTATE INC

\$79,500
MLS 7080934 Lake Home
38092 County Highway 44
Richville MN 56576



website: www.AffinityRealEstate.com | email: info@affinityrealestate.com | office: 218-237-3333 | fax:218-237-3377



\$79,500
MLS 7080934 Lake Home
38092 County Highway 44
Richville MN 56576

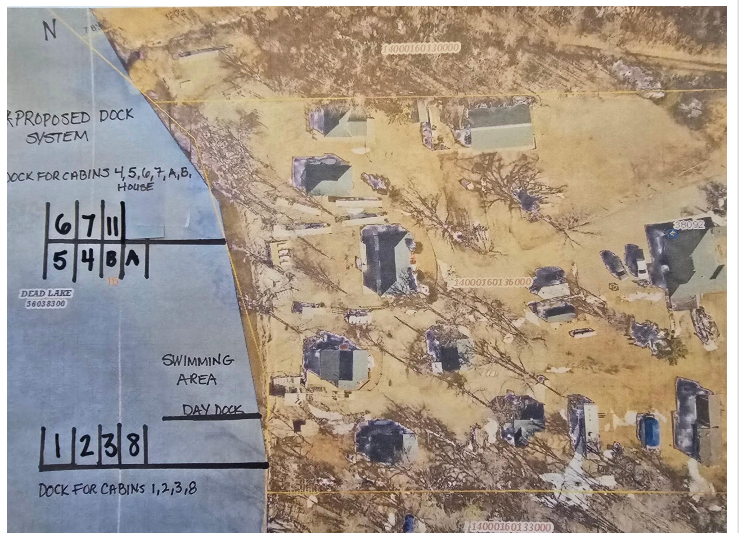

website: www.AffinityRealEstate.com | email: info@affinityrealestate.com | office: 218-237-3333 | fax: 218-237-3377



\$79,500
 MLS 7080934 Lake Home
 38092 County Highway 44
 Richville MN 56576



website: www.AffinityRealEstate.com | email: info@affinityrealestate.com | office: 218-237-3333 | fax:218-237-3377



\$79,500
MLS 7080934 Lake Home
38092 County Highway 44
Richville MN 56576



website: www.AffinityRealEstate.com | email: info@affinityrealestate.com | office: 218-237-3333 | fax:218-237-3377



\$79,500
MLS 7080934 Lake Home
38092 County Highway 44
Richville MN 56576