



MLS 7085093 Lake Home

**\$219,900**

408 sq ft  
1 bedrooms  
1 baths

51305 Curly Drive  
Deer Creek MN 56527

Waterfront: East Leaf

Status: Active

**Description:**

Peace, privacy, and lake life await! Situated on over an acre of wooded land with 150 feet of frontage on beautiful East Leaf Lake, this charming park model cabin is the perfect lakeside retreat. Featuring 1 bedroom, 1 bathroom, a loft for extra sleeping space, a comfortable living area, and an expansive deck offering beautiful views of the wooded property, you'll have plenty of room to relax and enjoy the outdoors. Whether you're fishing, boating, gathering around the campfire, or simply taking in the peaceful surroundings, this property offers everything you need to enjoy lake life at its best. Make this your new favorite place to create memories that last a lifetime.

**Additional Details:**

Year Built	2006
Lot Acres	1.05
Lot Dimensions	150x305
School District	545
Taxes	\$1,417
Taxes with Assessments	\$1,502
Tax Year	2026

**Additional Features:**

**Basement:** None **Fuel:** Electric **Heat:** Baseboard **Sewer:** Tank with Drainage Field **Water:** Well **Air Conditioning:** Wall Unit(s)

**Driving Directions:**

.

 Listed By:  
NextHome Legendary Properties

Affinity Real Estate Inc. participates in the Regional Multiple Listing Service of Minnesota, Inc Broker Reciprocity (sm) program, allowing us to display other broker's listings on our website. All properties are subject to prior sale, change or withdrawal.

 **Call Affinity Real Estate**  
**218-237-3333**  
**info@affinityrealestate.com**

    
Affinity Real Estate - 600 Park Avenue South - Park Rapids MN 56470



website: [www.AffinityRealEstate.com](http://www.AffinityRealEstate.com) | email: [info@affinityrealestate.com](mailto:info@affinityrealestate.com) | office: 218-237-3333 | fax:218-237-3377



**\$219,900**  
MLS 7085093 Lake Home  
51305 Curly Drive  
Deer Creek MN 56527



website: [www.AffinityRealEstate.com](http://www.AffinityRealEstate.com) | email: [info@affinityrealestate.com](mailto:info@affinityrealestate.com) | office: 218-237-3333 | fax: 218-237-3377

**Affinity**  
REAL ESTATE INC

**\$219,900**  
MLS 7085093 Lake Home  
51305 Curly Drive  
Deer Creek MN 56527



website: [www.AffinityRealEstate.com](http://www.AffinityRealEstate.com) | email: [info@affinityrealestate.com](mailto:info@affinityrealestate.com) | office: 218-237-3333 | fax:218-237-3377



**\$219,900**  
MLS 7085093 Lake Home  
51305 Curly Drive  
Deer Creek MN 56527



website: [www.AffinityRealEstate.com](http://www.AffinityRealEstate.com) | email: [info@affinityrealestate.com](mailto:info@affinityrealestate.com) | office: 218-237-3333 | fax:218-237-3377



**\$219,900**  
MLS 7085093 Lake Home  
51305 Curly Drive  
Deer Creek MN 56527

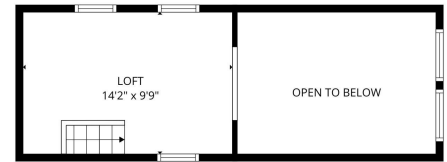

2nd floor



1st floor

FLOOR PLAN CREATED BY CUBICASA APP. MEASUREMENTS DEEMED HIGHLY RELIABLE BUT NOT GUARANTEED.

website: [www.AffinityRealEstate.com](http://www.AffinityRealEstate.com) | email: [info@affinityrealestate.com](mailto:info@affinityrealestate.com) | office: 218-237-3333 | fax:218-237-3377



**\$219,900**  
MLS 7085093 Lake Home  
51305 Curly Drive  
Deer Creek MN 56527