



MLS 7085369 Residential

\$525,000

2,140 sq ft
3 bedrooms
2 baths

34602 250th Avenue
Erhard MN 56534

Status: Active

Description:

20 Acres | 3 Bedrooms + Office | 36x40 Pole barn with tack room complete with heated floors | Pasture Land and so much more!

Located just an easy drive outside of town this picturesque retreat is the private, secluded oasis you truly get to and the weight and busyness of the world just falls off.

Pulling off the road, down your driveway you will breathe in the awesome country air and take in the gorgeous views overlooking a large pond, grazing lands for your future animals, a beautiful, newly constructed chicken coop, a pole barn complete with tack room inclusive of in-floor heat, and a Ritchie already setup and operational! Gardens abound as well with fresh asparagus, raspberry bushes, honey berries, apple and peach trees just waiting for your future harvesting.

The home has been wonderfully updated from top to bottom during the current ownership. 3 bedrooms plus the addition of an office, 2 bathrooms, a newly finished basement and family room. The home has room to spread out and the comfort and coziness you hope for all in one!

Recent updates include but are not limited to: Updating lighting to LED, all new kitchen appliances, new door into house from garage, insulated and finished garage with added trench drain, new 16x8 overhead garage door, added electrical in garage and barn, brand new 16x16 outbuilding with loft, 16x20 outdoor cover area with power.

If it's a true home base you are seeking for yourself and your loved ones, look no further. This home will capture you from the moment you step on the property and you will not want to let it go!

Additional Details:

Year Built	1993
Lot Acres	20
Lot Dimensions	1300x658x1300x663
Garage Stalls	2
School District	548



Listed By: \$2,007
 \$2,092
 2026
 Affinity Real Estate Inc. participates in the Regional Multiple Listing Service of Minnesota, Inc Broker Reciprocity (sm) program, allowing us to display other broker's listings on our website. All properties are subject to prior sale, change or withdrawal.
Additional Features: Fuel, Propane Heat, Dual Fuel Oil Peak, Forced Air



Call Affinity Real Estate
218-237-3333
info@affinityrealestate.com



Affinity Real Estate - 600 Park Avenue South - Park Rapids MN 56470



website: www.AffinityRealEstate.com | email: info@affinityrealestate.com | office: 218-237-3333 | fax:218-237-3377



\$525,000
MLS 7085369 Residential
34602 250th Avenue
Erhard MN 56534



website: www.AffinityRealEstate.com | email: info@affinityrealestate.com | office: 218-237-3333 | fax:218-237-3377



\$525,000
MLS 7085369 Residential
34602 250th Avenue
Erhard MN 56534



website: www.AffinityRealEstate.com | email: info@affinityrealestate.com | office: 218-237-3333 | fax:218-237-3377

Affinity
REAL ESTATE INC

\$525,000
MLS 7085369 Residential
34602 250th Avenue
Erhard MN 56534



website: www.AffinityRealEstate.com | email: info@affinityrealestate.com | office: 218-237-3333 | fax:218-237-3377

Affinity
REAL ESTATE INC

\$525,000
MLS 7085369 Residential
34602 250th Avenue
Erhard MN 56534



website: www.AffinityRealEstate.com | email: info@affinityrealestate.com | office: 218-237-3333 | fax: 218-237-3377

Affinity
REAL ESTATE INC

\$525,000
MLS 7085369 Residential
34602 250th Avenue
Erhard MN 56534



website: www.AffinityRealEstate.com | email: info@affinityrealestate.com | office: 218-237-3333 | fax: 218-237-3377

Affinity
REAL ESTATE INC

\$525,000
MLS 7085369 Residential
34602 250th Avenue
Erhard MN 56534



website: www.AffinityRealEstate.com | email: info@affinityrealestate.com | office: 218-237-3333 | fax:218-237-3377

Affinity
REAL ESTATE INC

\$525,000
MLS 7085369 Residential
34602 250th Avenue
Erhard MN 56534



website: www.AffinityRealEstate.com | email: info@affinityrealestate.com | office: 218-237-3333 | fax:218-237-3377

Affinity
REAL ESTATE INC

\$525,000
MLS 7085369 Residential
34602 250th Avenue
Erhard MN 56534



website: www.AffinityRealEstate.com | email: info@affinityrealestate.com | office: 218-237-3333 | fax:218-237-3377



\$525,000
MLS 7085369 Residential
34602 250th Avenue
Erhard MN 56534

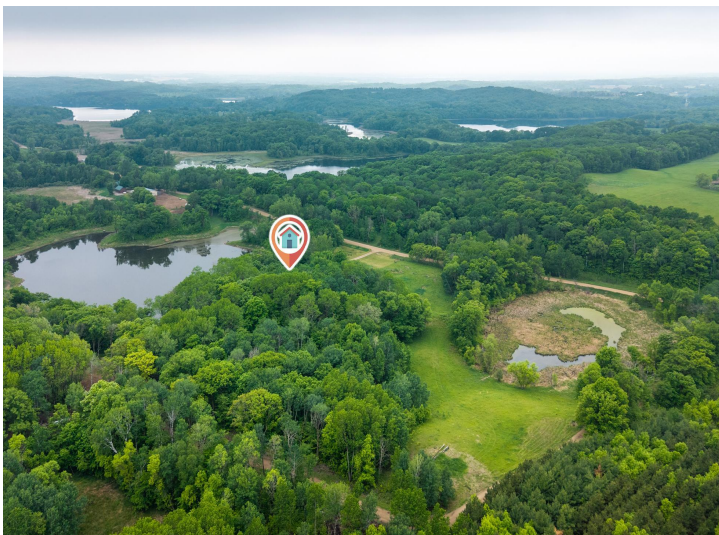
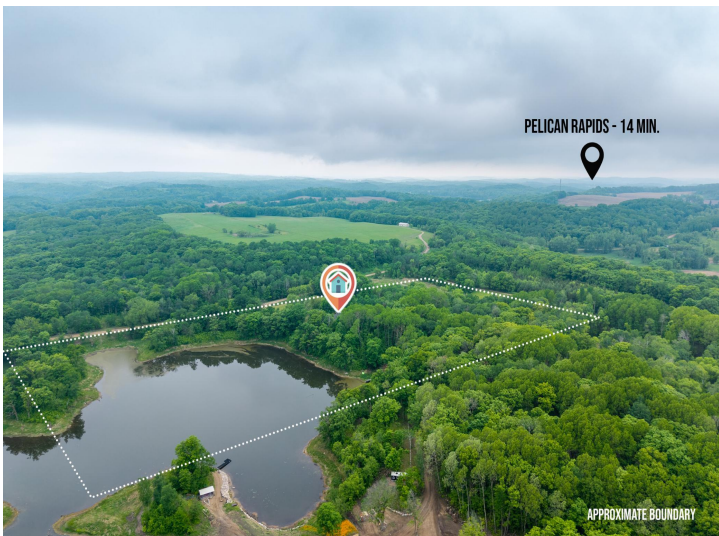

website: www.AffinityRealEstate.com | email: info@affinityrealestate.com | office: 218-237-3333 | fax:218-237-3377



\$525,000
MLS 7085369 Residential
34602 250th Avenue
Erhard MN 56534



website: www.AffinityRealEstate.com | email: info@affinityrealestate.com | office: 218-237-3333 | fax:218-237-3377



\$525,000
MLS 7085369 Residential
34602 250th Avenue
Erhard MN 56534