



MLS 7089046 Residential

\$379,000

2,184 sq ft
4 bedrooms
2 baths

22478 County Highway 20
Detroit Lakes MN 56501

Status: Active

Description:

Beautifully renovated 4-bedroom, 2-bathroom home situated on 5 acres only 10 miles south of Detroit Lakes, MN. This move-in-ready property features a brand-new kitchen with updated cabinetry and appliances, new flooring throughout, and tastefully remodeled bathrooms. The spacious lower-level family room offers the perfect gathering space, complete with a wet bar and an additional bonus room ideal for a home office, gym, or hobby space. Outside, you'll appreciate the oversized heated 3-stall garage with plenty of room for vehicles, storage, and projects. Enjoy the peace and privacy of country living with all the modern updates already completed.

Additional Details:

Year Built	1975
Lot Acres	5.02
Lot Dimensions	5.02 acres
Garage Stalls	3
School District	548
Taxes	\$1,352
Taxes with Assessments	\$1,352
Tax Year	2025

Additional Features:

Fuel: Propane **Heat:** Forced Air

Driving Directions:

From US-Hwy 10 in Detroit Lakes, head south on US-59 about 10 miles, take a right onto Grace Drive (Co Hwy 20), go about half a mile to address on right.



Listed By:
eXp Realty

Affinity Real Estate Inc. participates in the Regional Multiple Listing Service of Minnesota, Inc Broker Reciprocity (sm) program, allowing us to display other broker's listings on our website. All properties are subject to prior sale, change or withdrawal.



Call Affinity Real Estate

218-237-3333

info@affinityrealestate.com



Affinity Real Estate - 600 Park Avenue South - Park Rapids MN 56470



website: www.AffinityRealEstate.com | email: info@affinityrealestate.com | office: 218-237-3333 | fax:218-237-3377



\$379,000
MLS 7089046 Residential
22478 County Highway 20
Detroit Lakes MN 56501



website: www.AffinityRealEstate.com | email: info@affinityrealestate.com | office: 218-237-3333 | fax: 218-237-3377



\$379,000
MLS 7089046 Residential
22478 County Highway 20
Detroit Lakes MN 56501



website: www.AffinityRealEstate.com | email: info@affinityrealestate.com | office: 218-237-3333 | fax:218-237-3377



\$379,000
MLS 7089046 Residential
22478 County Highway 20
Detroit Lakes MN 56501



website: www.AffinityRealEstate.com | email: info@affinityrealestate.com | office: 218-237-3333 | fax:218-237-3377



\$379,000
MLS 7089046 Residential
22478 County Highway 20
Detroit Lakes MN 56501

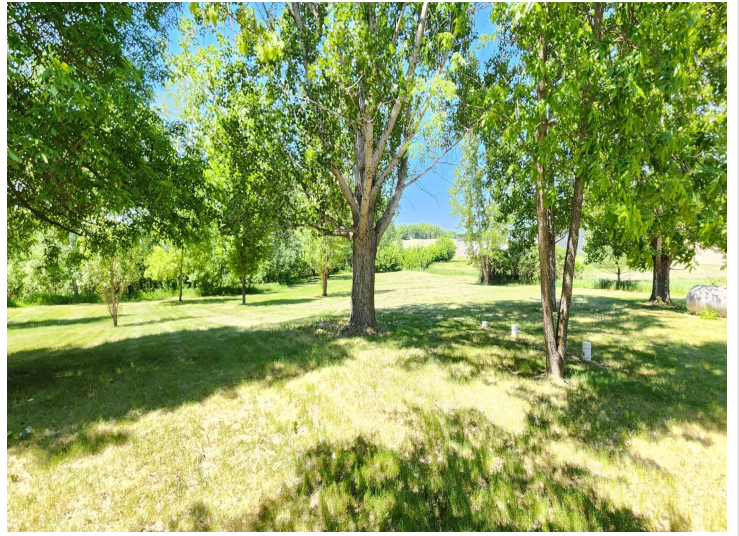

website: www.AffinityRealEstate.com | email: info@affinityrealestate.com | office: 218-237-3333 | fax:218-237-3377



\$379,000
MLS 7089046 Residential
22478 County Highway 20
Detroit Lakes MN 56501



website: www.AffinityRealEstate.com | email: info@affinityrealestate.com | office: 218-237-3333 | fax:218-237-3377



\$379,000
MLS 7089046 Residential
22478 County Highway 20
Detroit Lakes MN 56501