



MLS 7101415 Residential

\$329,900

1,840 sq ft
4 bedrooms
2 baths

1221 Roosevelt Avenue
Detroit Lakes MN 56501

Status: Active

Description:

Looking for a move-in ready home in a great location? This 4-bedroom, 2-bath rambler checks all the boxes. With 3 bedrooms on the main level, an updated kitchen, newer appliances, and a finished basement, there's plenty of space for everyone.

The lower level features a large family room, beautiful full bathroom, and 4th bedroom, creating the perfect space for guests, hobbies, or simply spreading out. Major updates including, HVAC, shingles, windows, gutters, driveway, and landscaping have already been completed, allowing you to move in and enjoy.

Step outside to a fully fenced backyard complete with a pergola, patio, and room to relax, entertain, or let kids and pets play. Conveniently located near schools, parks, and other Detroit Lakes amenities, this well-maintained home offers comfort, space, and a location you'll love.

Additional Details:

Year Built	1956
Lot Acres	0.22
Lot Dimensions	Irregular
Garage Stalls	1
School District	22
Taxes	\$2,069
Taxes with Assessments	\$2,154
Tax Year	2026

Additional Features:

Basement: Full **Fuel:** Natural Gas **Garage:** 1 **Heat:** Forced Air **Sewer:** City Sewer/Connected **Water:** City Water/Connected **Air Conditioning:** Central Air

Driving Directions:

Just North of Detroit Lakes Highschool



Listed By:
HomeSmart Adventure Realty

Affinity Real Estate Inc. participates in the Regional Multiple Listing Service of Minnesota, Inc Broker Reciprocity (sm) program, allowing us to display other broker's listings on our website. All properties are subject to prior sale, change or withdrawal.



Call Affinity Real Estate

218-237-3333

info@affinityrealestate.com



Affinity Real Estate - 600 Park Avenue South - Park Rapids MN 56470



website: www.AffinityRealEstate.com | email: info@affinityrealestate.com | office: 218-237-3333 | fax: 218-237-3377

Affinity
REAL ESTATE INC

\$329,900
MLS 7101415 Residential
1221 Roosevelt Avenue
Detroit Lakes MN 56501



website: www.AffinityRealEstate.com | email: info@affinityrealestate.com | office: 218-237-3333 | fax:218-237-3377

Affinity
REAL ESTATE INC

\$329,900
MLS 7101415 Residential
1221 Roosevelt Avenue
Detroit Lakes MN 56501



website: www.AffinityRealEstate.com | email: info@affinityrealestate.com | office: 218-237-3333 | fax: 218-237-3377

Affinity
REAL ESTATE INC

\$329,900
MLS 7101415 Residential
1221 Roosevelt Avenue
Detroit Lakes MN 56501



website: www.AffinityRealEstate.com | email: info@affinityrealestate.com | office: 218-237-3333 | fax: 218-237-3377

Affinity
REAL ESTATE INC

\$329,900
MLS 7101415 Residential
1221 Roosevelt Avenue
Detroit Lakes MN 56501



website: www.AffinityRealEstate.com | email: info@affinityrealestate.com | office: 218-237-3333 | fax:218-237-3377



\$329,900
MLS 7101415 Residential
1221 Roosevelt Avenue
Detroit Lakes MN 56501

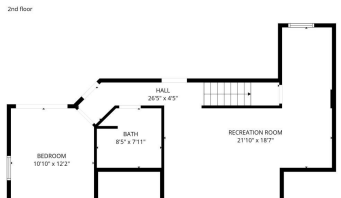

FLOOR PLAN CREATED BY CURICASA APP. MEASUREMENTS DEEMED HIGHLY RELIABLE BUT NOT GUARANTEED.

website: www.AffinityRealEstate.com | email: info@affinityrealestate.com | office: 218-237-3333 | fax:218-237-3377



\$329,900
 MLS 7101415 Residential
 1221 Roosevelt Avenue
 Detroit Lakes MN 56501