



MLS 6514323 Land

**\$65,000**

1.84 Acres  
Raw Land

TBD Elliot Road  
Bemidji MN 56601

Status: Active

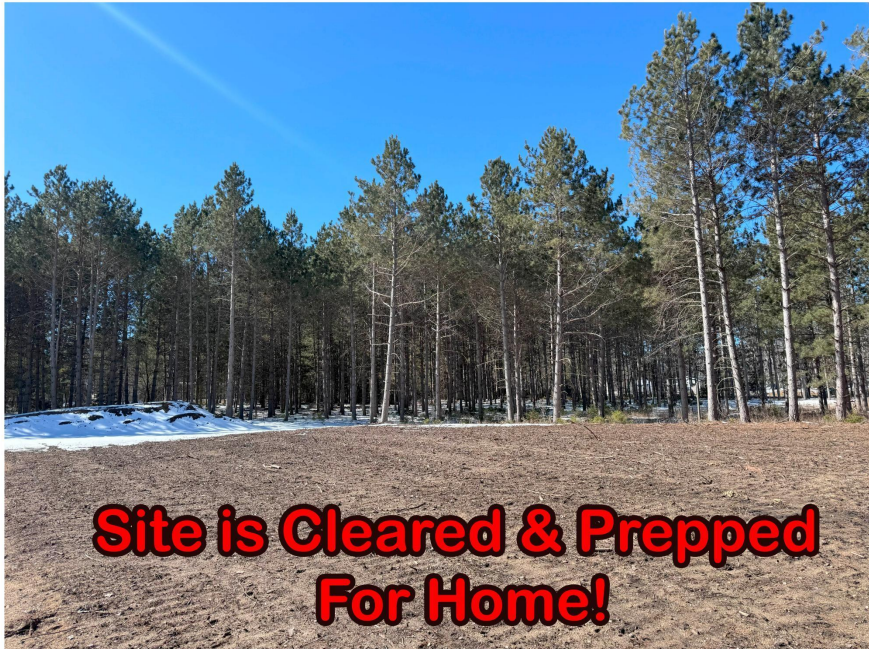

**Description:**

This beautiful wooded 1.8 acre building lot is ready for a new home. It's located in the highly desirable Elliot Rd neighborhood located on Bemidji's east side. If you like to walk, bike or hunt this neighborhood is for you! This lot sits very close to Bemidji's east side walking trail and across the street is the State game refuge.

**Additional Details:**

Lot Acres	1.84
Lot Dimensions	320x560
School District	31
Taxes	\$352
Taxes with Assessments	\$352
Tax Year	2024

**Additional Features:**

**Driving Directions:**

North on Lake Ave, right on Elliot Rd, property on the right.



Listed By:  
CENTURY 21 Dickinson Realtors

Affinity Real Estate Inc. participates in the Regional Multiple Listing Service of Minnesota, Inc Broker Reciprocity (sm) program, allowing us to display other broker's listings on our website. All properties are subject to prior sale, change or withdrawal.



**Call Affinity Real Estate**

**218-237-3333**

**info@affinityrealestate.com**



**Affinity Real Estate - 600 Park Avenue South - Park Rapids MN 56470**